

**REPORT of Brevt. Lt. Col. E.B. WHITMAN LATE Capt. A.Q.M. U.S.V.  
Supt. National Cemeteries  
Dept. of the Cumberland  
Louisville KY. May 10th, 1869**

**Explorations of Battlefields, Cemeteries and places where UNION DEAD were interred  
SELECTION, ESTABLISHMENT AND COMPLETION of  
NATIONAL CEMETERIES WITH TABLES OF  
Mortuary Statistics, Views, Plans, Etc. MIL. DIV. OF THE TENNESSEE**

**Reference:**

**National Archives and Records Administration, Record Group 92: Records of the Office of the Quartermaster General, 1774 – 1985,  
Entry 646: Report of Lt. Col. E. B. Whitman, Superintendent of National Cemeteries, Department of the Cumberland, Louisville, KY,  
May 1869, 1 oversize volume**

# REPORT

Brent. Lt. Col.

**E. D. WHITMAN**

Capt. A. Q. M. U. S. A.

*Sup<sup>t</sup> National Cemeteries*

*Dep<sup>t</sup> of the Cumberland*

*Louisville K<sup>y</sup> May 10. 1869*

*Embracing*

*Explorations of Battle fields Cemeteries and places where UNION DEAD were interred*

*SELECTION*

*ESTABLISHMENT*

*COMPLETION*

AND

**NATIONAL CEMETERIES**

*WITH*  
**TABLES OF**

**Mortuary Statistics**

*Shows Plans &c*

**MIL. DIV. OF**

**TENNESSEE**



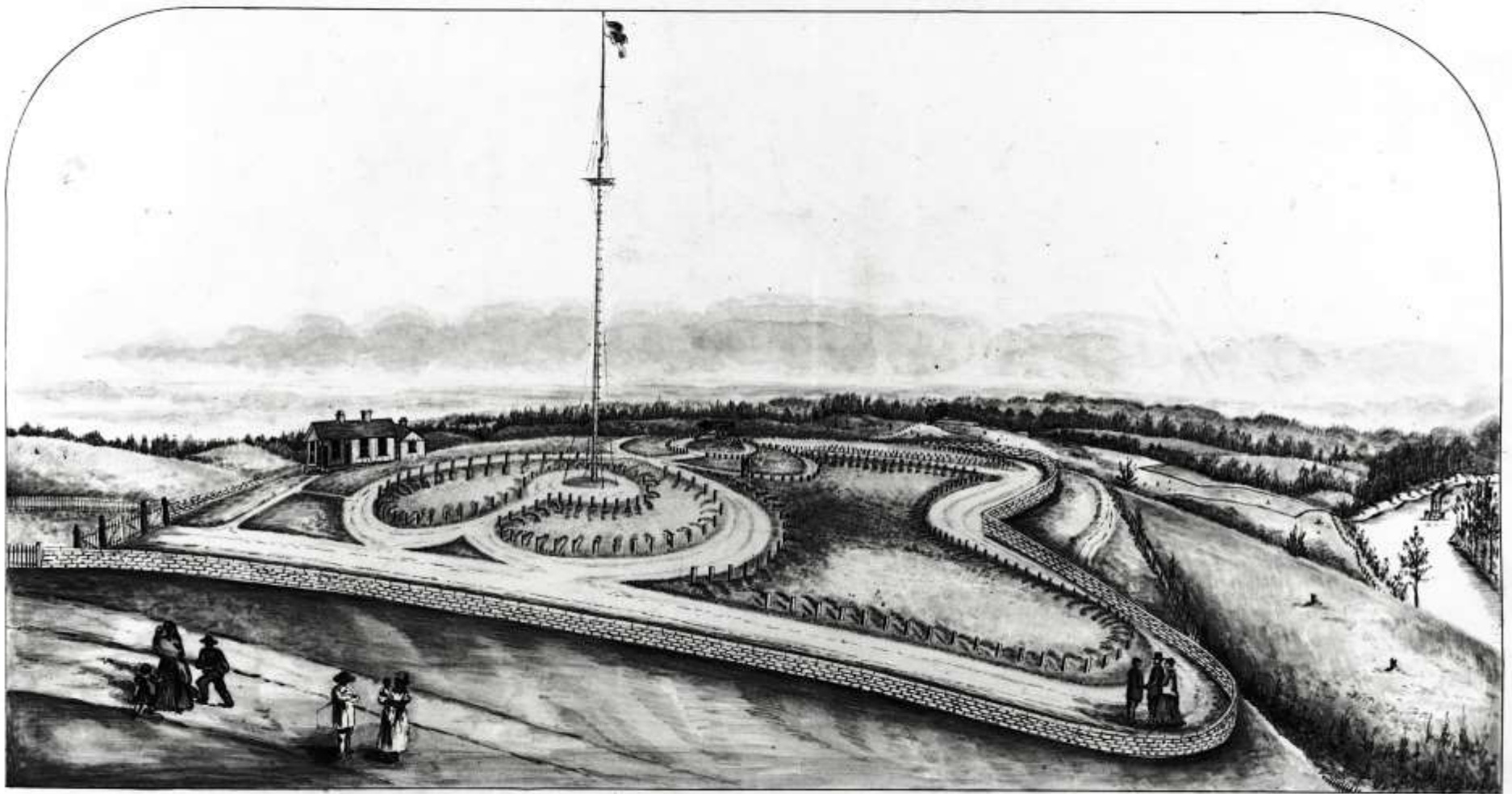

View  
of  
Fort Donelson National Cemetery  
near  
Dover Tennessee

Plat of  
 U. S. National Cemetery at  
 Fort Donelson  
 Tennessee

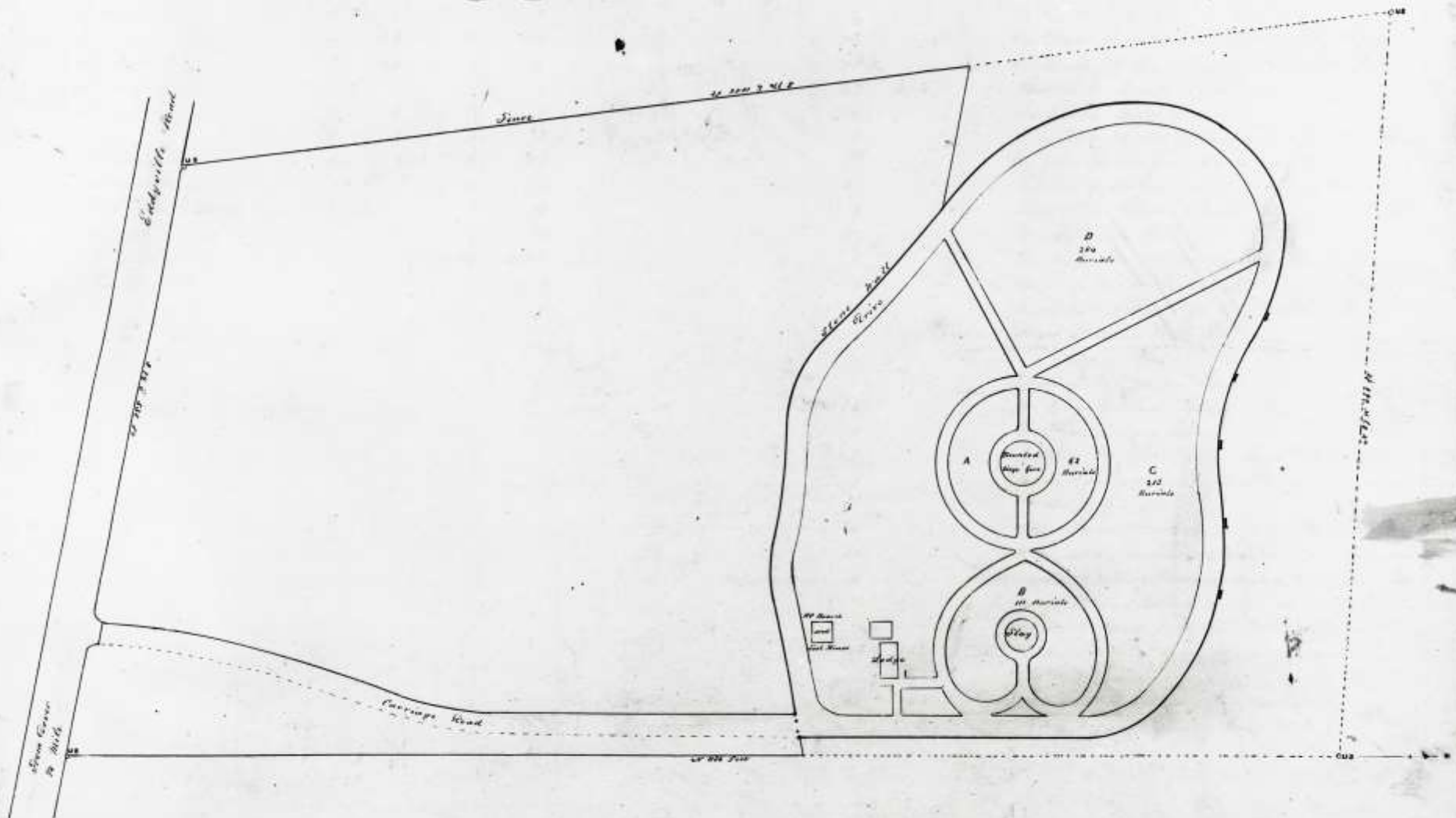

Scale

Area 10 <sup>25</sup>/<sub>100</sub> Acres

## RECAPITULATION.

By States, of the Identified Union Dead, and of Unknown and Miscellaneous Interred in the Cumberland River National Cemetery at Fort Donelson, Tennessee (as reported on Rolls of Honor.)

## RECAPITULATION.

By Localities of Original Interment, from which the Union Dead have been removed to the Cumberland River National Cemetery at Fort Donelson, Tenn.; showing the aggregate number from each, and the number of separate and distinct groups, or locations in which the bodies were found, (as reported on Burial Sheets.)

STATE OR ORGANIZATION.	No. REGIMENTS REPRESENTED.	KNOWN.	UNKNOWN.	TOTAL.	STATE.	PLACE OF ORIGINAL BURIAL.	No. BODIES.	TOTAL No.	SEPARATE PLACES OF INTERMENT.	REMARKS (EXPLANATORY.)
Illinois	14	67	62	129	Tenn	Fort Donelson Battlefield	285			
Indiana	5	8	-	8	.	.	6			At the Fort
Iowa	3	13	2	15	.	.	16			On Widow Knipfs land, Field Hospital, 2 m W of Fort
Kentucky	7	28	-	28	.	.	18			On Bank of the Cumberland, 2 m below the Fort
Minnesota	1	1	-	1	.	.	62	379	40	Battlefield Group, 11 <sup>th</sup> Illinois
Missouri	1	5	-	5	.	Dover	154			At Village Grave Yard
Ohio	3	8	-	8	.	Vicinity of Dover	8			Field Hospital, east of J Mathus house, 2 m from Dover
Wisconsin	2	9	2	11	.	.	17			On John Kinsons farm, 2 miles from Dover
M. M. Brigade		5	-	5	.	.	27			Hospital at Rollins house, 1/2 mile S of Dover
U. S. Colored Troops	2	4	8	12	.	.	5			Hospital on Widow Churgs land, 2 m S of Dover
Miscellaneous		26	-	26	.	.	22			On Robinsons Hill
Unknown			134	434	.	.	5			On South Bank of Cumberland River
Employee		1	-	1	.	.	4			South of Mrs Walters house
					.	.	1			South-east of Randolphs Forge & Dover Road
					.	.	1			Near Federal Rifle pits
					.	.	3			Coopers Hotel
					.	.	1			North of Mrs Jolyons house
					.	.	1			At Georges Benharts Garden
					.	.	1			On Wrens Ferry Road
					.	.	2			South of Mrs Walters house, Forge & Dover Road
					.	.	1			South of a Road running east & west on a ridge
					.	.	1			On North hill side
					.	.	5			Near Randolphs Forge in James Woods Grave yard
					.	.	11			200 yds south of Knut House, 200 yds West of Mrs Walters house
					.	.	4			1 mile south of Dover & 100 yds South of Wrens Ferry Road
					.	.	1			200 yds North of Village Cemetery at mouth of a hollow
					.	.	1	256	111	on south bank of the Cumberland River
					.	.				Under the house of Col Alexander, now occupied by Mrs Ham
					Ky	Hopkinsville	22	22	1	At Dover Cemetery
					!	La Fayette	2	2	1	At J G Jones family Grave yard
<b>Total</b>	<b>38</b>	<b>162</b>	<b>508</b>	<b>670</b>		<b>Total</b>		<b>670</b>	<b>153</b>	